

ProLandscaper

Concept to Delivery

April 2012

DESIGN, BUILD
AND MAINTAIN

Classic remake for
lakeside garden with
focal swimming pool
and terrace

ARUN LANDSCAPES

POOL OF TALENT



Let's Hear it from...

Q&A with Dan Riddleston,
Managing Director of
Bowles & Wyer Contracts



Lighting

LEDs are given a glowing
report as more and more
designers specify them

Portfolios

Discover how three
companies have designed and
implemented their projects



CHELSEA BECKONS

Society bringing its Fresh ideas to the 2012 Flower Show

The new Fresh Trade Stands category at the RHS Chelsea Flower Show will be home to the Society of Garden Designers this year with a stand designed by Amanda Patton MSGD and built by Bowles & Wyer Contracts. As the name implies, Fresh is the place for all things refreshing, bright and innovative and the SGD stand will be just that.

With bold colour-block planting from Palmstead nurseries set among large cubes in SGD corporate colours and an eye-catching wallpaper backdrop, it has a strong abstract feel. The hard landscaping will be supplied by Stockscape and contemporary furniture from Gloster will complete the look.

As in previous years, visitors will be able to receive a free garden design consultation from the stand, meet participating Registered Members and see their work on a series of posters displayed within the stand.

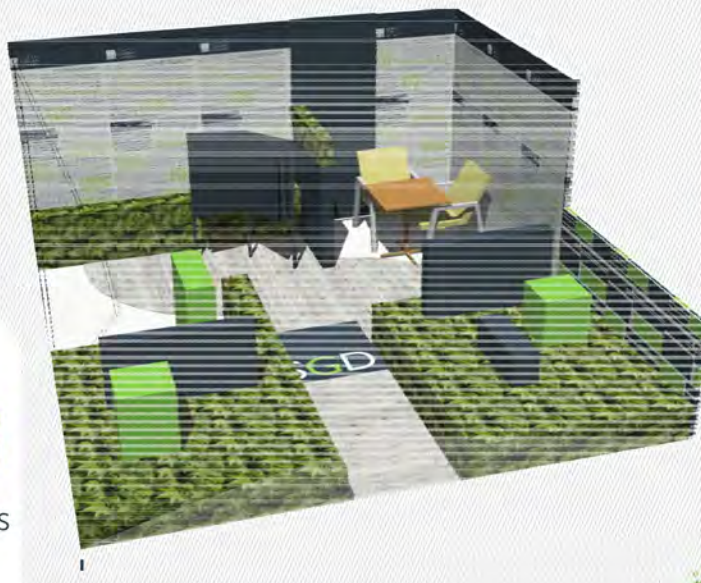

- 1 SGD stand at RHS Chelsea Flower Show 2011 by Amanda Patton MSGD.
- 2 The Homebase Garden by Joe Swift, Chelsea 2012.
- 3 M&G Garden by Andy Sturgeon.
- 4 Garden by Chris Deakin for The English Glasshouse Co and Aga.
- 5 Arthritis Research UK Garden by Thomas Hoblyn.

SGD Members at Chelsea

Many of the Society's Fellows (FSGD) and Registered Members (MSGD) will be back in residence along Chelsea's Main Avenue this year.

Cleve West MSGD returns from his triumphs in 2011 with a topiary garden for Brewin Dolphin; Andy Sturgeon FSGD will be showing a 'New English' garden for the Show's headline sponsor M&G Investments; and Tom Hoblyn MSGD is staging a garden inspired by the great Italian Renaissance gardens for Arthritis Research UK. Joining them will be broadcaster and designer Joe Swift MSGD and Patricia Fox MSGD who are staging Chelsea show gardens for the first time this year.

Other MSGD exhibiting gardens at the Show include Chris Deakin who is introducing an inside/outside garden concept and Nick Dexter and Chris Gutteridge, both of whom are appearing in the new Fresh Gardens area.

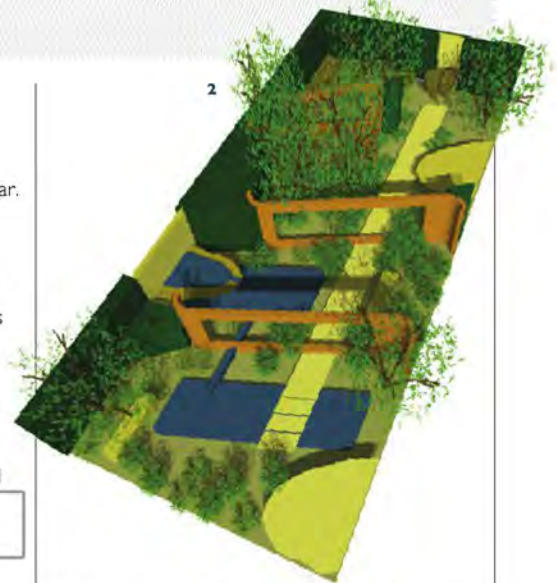

Further information on all the MSGD gardens at RHS Chelsea Flower Show 2012, taking place from 22 to 26 May, can be found on the SGD website: www.sgd.org.uk.

