

G THE ENGLISH GARDEN

100 FREE*
ALLIUMS
FOR EVERY
READER
*just pay P&P

MAY 2009

FOR EVERYONE WHO LOVES BEAUTIFUL GARDENS

£3.75 A\$9.50

Beth Chatto

SPEAKS ABOUT 50 YEARS
OF PIONEERING GARDENING

Creating borders

SHAPED, SIZZLING
AND PRAIRIE

AUTUMN
ASTERS
THE EXPERT'S CHOICE

www.theenglishgarden.co.uk



9 171361 08402



INSIDE THIS MONTH...

- FABULOUS FOLIAGE on show at Westonbirt
- LAWN CARE tips from RHS' Matthew Wilson
- Tasty recipes from FUNGI FORAYS
- NEW SERIES: Growing fine food at Otter Farm

Going for GOLD

Showcasing an exciting array of garden design at the very highest level, key themes at this year's RHS Chelsea include sustainability, foreign influences and edible gardens

Eco-friendly

FUTURE NATURE

An ingenious design from the green roof gurus at Ark DM and the University of Sheffield Landscape Department, this garden is 'a joyful celebration of water'. It is built around a water cycling system that is visible at the core of the garden - a novel approach to normal concepts for rainwater harvesting. Stand MA13

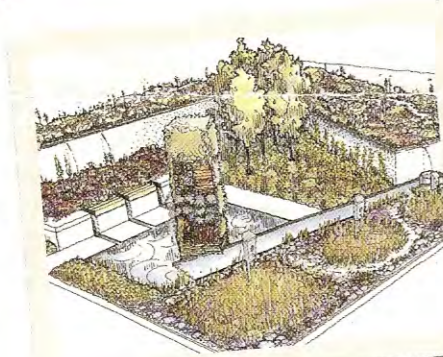

look out for...

A green roof that feeds water into a stormwater planting box, with planting able to tolerate both flooding and normally dry conditions



look out for...

Locally sourced, reclaimed steel mesh gabions densely planted with ivy to make a living wall to further help absorb water

THE HESCO GARDEN

Leeds City Council took inspiration from American-style rain gardens for their design, as the damp Yorkshire climate so familiar to the team proved to be the ideal environment for them. Water is directed into a pond flanked by shallow overflow pools, planted with iris, hosta and *Primula beesiana*. This system also creates free-draining areas that are perfect for geums, aquilegia and geraniums. Stand MA21



THE PILGRIM'S REST

Inspired by the herb gardens that were attached to monasteries in the Middle Ages, Chris O'Donoghue hopes to 'recreate the spirit of these small, peaceful plots'. All the plants used are easy to grow and many can be incorporated into modern dishes, such as meadowsweet (*Filipendula ulmaria*) and elder (*Sambucus nigra*) for fritters, and young side shoots of hops that can be cooked like asparagus. Stand RM16

THE GILES LANDSCAPES FENLAND ALCHEMIST GARDEN

'Using only reclaimed or discarded materials, this garden highlights the importance of recycling and sustainability in today's gardens,' say Stephen Hall and Jane Besser. Using many native and wild plants with cultivars from the same genus, the pair demonstrate their interest in what they see is a horticulturist's form of alchemy. Stand RM10

look out for...

Fen Ben's hovel - a traditional Fenland shed made from reclaimed materials

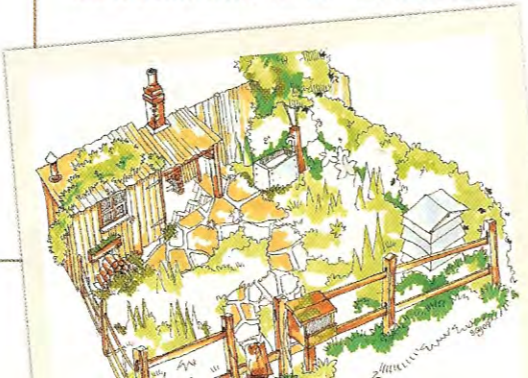

From plot to plate

THE CHILDREN'S SOCIETY GARDEN

Designer Mark Gregory says 'this is a chic, modern space for the urban family where you can grow seasonal vegetables and herbs for the table without your garden looking like an allotment'. Raised vegetable beds stand alongside buxus cubes and decorative planting and it is enclosed by a pollution tolerant, multi-stemmed ginkgo tree and *Pratia pendiculata* as a living alternative to fencing. Stand MA25

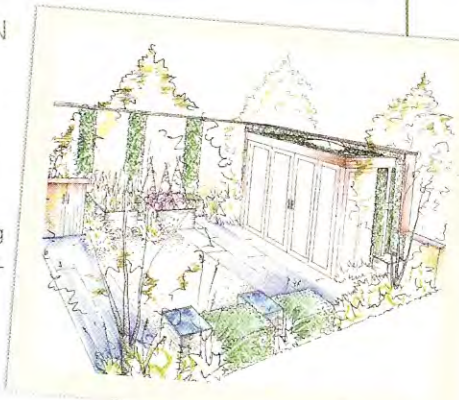

look out for...

Hidden composting and water-saving facilities. Plus an innovative solution for drying laundry, which reduces electricity consumption

FRESHLY PREPPED BY ARALIA

Designer Pat Fox claims 'absolutely everything can be eaten' in her garden. 'I've approached it as an extension of the kitchen - somewhere to whip up a sandwich or a smoothie using the freshest ingredients picked directly from the garden. I hope it will also show owners of small spaces how to start preparing and eating home-grown food'. Stand RM15



look out for...

A Chelsea first: the garden's living wall, which is entirely created using edible crops

look out for...

Authentic touches, including a thatched lovecote, a medieval pattern wheelbarrow, a chamomile seat and straw bee skeps

A world of ideas

ENTENTE CORDIAL

'All is not as it appears on first glance in our garden,' explain designers Patricia Thirion and Janet Honour. Sponsored by *The English Garden* and sister title *France* magazine, it explores cottage garden style on both sides of the Channel: the planting is typically French - formal and elegant - while the plants themselves are quintessentially English. Roses, peonies, delphiniums and foxgloves jostle for position against columnar *Taxus baccata*, used for structure. The pair have chosen drought-tolerant plants to reduce watering and specific species to attract insects into the garden. Stand RM14



look out for...

Clever container ideas, including planters filled with allium, chervil, artemisia and curly leaf parsley as well as hanging baskets spilling over with colourful annuals

CALLING ALL FRANCOPHILES

Subscribe to our sister title *France* magazine for £24 and save 50% on 12 issues. To subscribe, visit www.subscription.co.uk/france/EG59 or contact Tel: +44 (0)1858 438788 and quote EG59.

